

# Preliminary Plat

# Emerald Falls V

PART OF THE NORTH HALF (N/2) OF SECTION FIVE (5)  
TOWNSHIP EIGHTEEN (18) NORTH, RANGE SIXTEEN (16) EAST, OF THE INDIAN MERIDIAN  
AN ADDITION TO WAGONER COUNTY, STATE OF OKLAHOMA

OWNER:  
**Emerald Falls Investment Company, L.L.C.**  
AN OKLAHOMA LIMITED LIABILITY COMPANY  
12150 East 96th Street North  
Suite 202  
Owasso, OK 74055  
Phone: (918)376-6536

SURVEYOR/ENGINEER:  
**Tanner Consulting, L.L.C.**  
DAN E. TANNER, P.L.S. NO. 1435  
OK CA NO. 2661, EXPIRES 6/30/2021  
EMAIL: DAN@TANNERBAITSHOP.COM

5323 South Lewis Avenue  
Suite 202  
Tulsa, Oklahoma 74105  
Phone: (918) 745-9929

### Contact List

TANNER CONSULTING, LLC  
JUSTIN MORGAN  
5323 SOUTH LEWIS AVE  
TULSA, OK 74112  
PHONE: (918) 745-9929

ONG  
KIMBERLY VOSSLER  
5848 EAST 15th STREET  
TULSA, OK 74112  
PHONE: (918) 831-8251

LAKE REGION ELECTRIC COOPERATIVE  
516 S LAKE REGION ROAD  
HULBERT, OK 74441  
PHONE: (918) 772-2526

WAGONER COUNTY RURAL WATER  
DISTRICT #4  
RICK LANG  
916 S. 239th EAST AVE.  
BROKEN ARROW, OK 74014  
PHONE: (918) 258-2331

AT&T  
Kevin Bender  
5305 EAST 71st  
TULSA, OK 74136  
PHONE: (918) 859-9147

COX COMMUNICATIONS  
CHRIS LONG  
11811 EAST 51st ST.  
TULSA OK 74145  
PHONE: (918) 286-4665

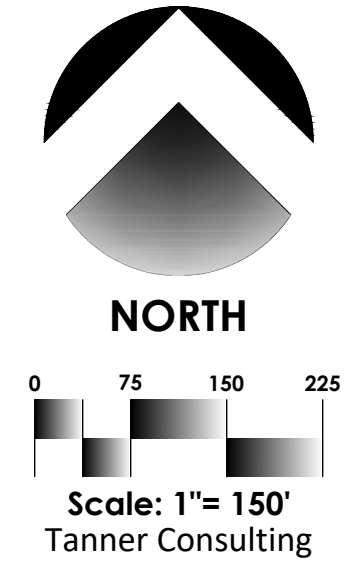

**LEGEND**

B/L	BUILDING LINE
B/U	BUILDING LINE & UTILITY EASEMENT
BK PG	BOOK & PAGE
CB	CHORD BEARING
CD	CHORD DISTANCE
CL	CENTERLINE
Δ	DELTA ANGLE
DOC	DOCUMENT
ESMT	EASEMENT
GOV'T	GOVERNMENT
LNA	LIMITS OF NO ACCESS
ODE	OVERLAND DRAINAGE EASEMENT
RES.	RESERVE
R/W	RIGHT-OF-WAY
U/E	UTILITY EASEMENT
1234	ADDRESS ASSIGNED
○	FOUND MONUMENT
●	SET MONUMENT (SEE NOTE 2)

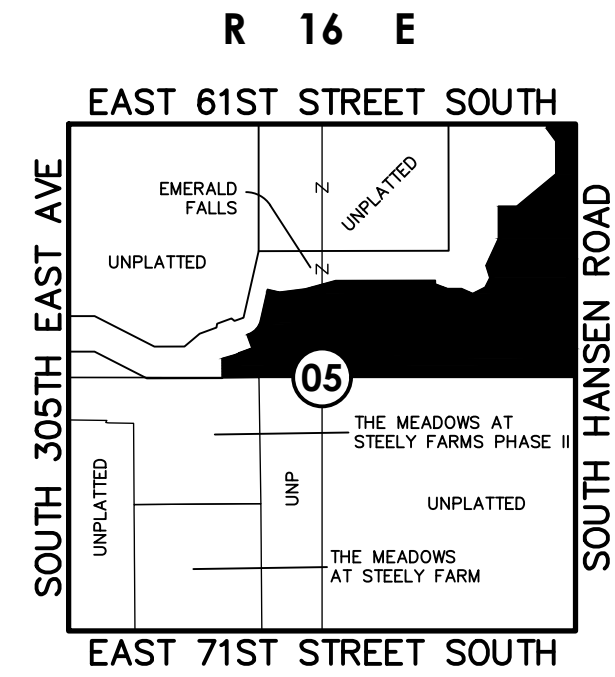

**Location Map**  
Scale: 1"= 2000'

### Curve Table

CURVE	LENGTH(L)	RADIUS(R)	DELTA(A)	CHORD(B)	CHORD(D)
1	122.18'	100.00'	70°00'10"	N56°27'44"W	114.72'
2	183.27'	150.00'	70°00'10"	N56°27'44"W	172.08'
3	39.27'	25.00'	90°00'00"	N43°32'11"E	35.36'
4	39.27'	25.00'	90°00'00"	N46°27'49"W	35.36'
5	243.47'	77.50'	180°00'00"	N88°32'11"E	155.00'
6	400.55'	127.50'	180°00'00"	N88°32'11"E	255.00'
7	95.50'	275.68'	19°50'56"	N78°35'13"E	95.03'
8	112.88'	325.00'	19°53'59"	N78°35'11"E	112.31'
9	39.27'	25.00'	89°59'58"	N66°21'50"W	35.36'
10	44.60'	25.00'	102°12'46"	N29°44'32"E	38.92'
11	327.55'	355.00'	52°51'53"	N84°55'52"W	316.05'
12	209.31'	294.98'	40°39'20"	N78°49'30"W	204.95'
13	243.14'	110.00'	126°38'44"	N84°26'51"W	196.58'
14	376.18'	170.00'	126°47'14"	N84°35'12"W	303.99'
15	39.27'	25.00'	90°00'00"	N13°29'56"W	35.36'
16	39.27'	25.00'	90°00'00"	N76°30'04"E	35.36'
17	140.11'	245.00'	32°45'56"	N74°52'55"W	138.21'
18	109.43'	127.53'	49°09'45"	N64°06'24"E	106.10'
19	39.27'	25.00'	90°00'00"	N84°31'37"E	35.36'
20	39.27'	25.00'	90°00'00"	N5°28'23"W	35.36'
21	85.85'	120.00'	40°59'27"	N70°58'06"W	84.03'
22	128.78'	180.00'	40°59'27"	N70°58'06"W	126.05'
23	188.47'	120.00'	89°59'08"	N43°32'37"E	169.68'
24	282.70'	180.00'	89°59'08"	N43°32'37"E	254.53'
25	129.94'	119.92'	62°04'54"	N32°28'44"W	123.67'
26	196.00'	180.00'	62°23'15"	N32°38'35"W	186.46'
27	39.27'	25.00'	90°00'00"	N70°40'30"E	35.36'
28	39.06'	25.00'	89°30'42"	N19°04'51"W	35.20'
29	53.19'	220.00'	13°51'07"	N32°36'03"E	53.06'
30	67.69'	280.00'	13°51'07"	N32°36'03"E	67.53'
31	197.53'	180.00'	62°52'33"	N57°06'46"E	187.77'
32	131.69'	120.00'	62°52'33"	N57°06'46"E	125.18'
33	39.27'	25.00'	90°00'00"	N43°33'03"E	35.36'
34	39.27'	25.00'	90°00'00"	N46°26'57"W	35.36'

### Notes:

- THIS PLAT MEETS THE OKLAHOMA MINIMUM STANDARDS FOR THE PRACTICE OF LAND SURVEYING AS ADOPTED BY THE OKLAHOMA STATE BOARD OF LICENSURE FOR PROFESSIONAL ENGINEERS AND LAND SURVEYORS.
- ALL PROPERTY CORNERS ARE SET 3/8" IRON REBAR WITH YELLOW CAP STAMPED "TANNER 1435" UNLESS OTHERWISE NOTED.
- THE BEARINGS SHOWN HEREON ARE BASED UPON THE OKLAHOMA STATE PLANE COORDINATE SYSTEM, NORTH ZONE (3501), NORTH AMERICAN DATUM 1983 (NAD83); SAID BEARINGS ARE BASED LOCALLY UPON FIELD-OBSERVED TIES TO THE FOLLOWING MONUMENTS:
  - (a) FOUND 3/8" IRON PIN AT THE NORTHEAST CORNER OF THE NORTHEAST QUARTER (NE/4) OF SECTION 5;
  - (b) FOUND 3/8" IRON PIN AT THE SOUTHEAST CORNER OF THE NORTHEAST QUARTER (NE/4) OF SECTION 5;
 THE BEARING BETWEEN SAID MONUMENTS BEING SOUTH 1°26'57" EAST.
- ADDRESSES SHOWN ON THIS PLAT WERE PROVIDED BY WAGONER COUNTY AND ARE ACCURATE AT THE TIME THE PLAT WAS FILED. ADDRESSES ARE SUBJECT TO CHANGE AND SHOULD NEVER BE RELIED ON IN PLACE OF THE LEGAL DESCRIPTION.
- ACCESS AT THE TIME OF PLAT WAS PROVIDED BY SOUTH HANSEN ROAD BY VIRTUE OF RIGHT-OF-WAY DEDICATED BY THIS PLAT.

WE THE UNDERSIGNED HEREBY CERTIFY THAT THE PLAT DESIGNATED HEREIN AS "EMERALD FALLS PHASE V" HAS BEEN PREPARED IN ACCORDANCE WITH THE REGULATIONS AND REQUIREMENTS OF WAGONER COUNTY, OKLAHOMA AS RESPECTIVELY PERTAIN TO THE OWNER, THE ENGINEER, AND THE SURVEYOR.

[SIGNATORY NAME]  
[SIGNATORY TITLE] OF FIRST PAR. LLC  
C/O EMERALD FALLS INVESTMENT COMPANY, LLC  
AN OKLAHOMA LIMITED LIABILITY COMPANY

DAN E. TANNER  
LICENSED PROFESSIONAL ENGINEER  
OKLAHOMA NO. 13090  
LICENSED PROFESSIONAL LAND SURVEYOR  
OKLAHOMA NO. 1435  
OKLAHOMA C.A. NO. 2661

